

# Build a 1:20.3-scale loading platform for a dump truck

by Ted Stinson | Wiscasset, Maine

If your railroad handles freight, you will need a number of loading platforms. This particular platform would be used to load bulk goods of any sort into gondolas. If you are modeling a small narrow-gauge line, it can be used to load coal into a tender. The drawing shows a 1:20.3-scale dump truck, a kit for which can be purchased from Northeast Model Products (see [www.nemodel.com](http://www.nemodel.com)).

## Construction

This model can be assembled with carpenter's yellow glue. When dry, this aliphatic-resin glue is quite weather resistant, particularly when sealed and painted.

Cut two pieces of  $\frac{1}{8}$ " plywood to  $6\frac{1}{2}$ " x  $7\frac{1}{2}$ ". Notch the pieces as shown—the ramp will need only two notches. Cut 8 pieces of  $\frac{1}{2}$ " x  $\frac{1}{2}$ " x  $2\frac{1}{2}$ " pine strip. Fit and glue these into the

notches of the top piece. Fit, cut, and glue a piece of  $\frac{1}{8}$ " x  $\frac{1}{2}$ " strip around one end. This should be recessed to allow the ramp to rest at the same height as the top. Make the ramp with two pieces of  $\frac{1}{2}$ "-square stock set into the side notches. Use the plan to cut these to shape.

Now fit, cut, and glue  $\frac{1}{8}$ " x  $\frac{1}{2}$ " strip flush with the top of the ramp and the deck. Follow this with  $\frac{1}{8}$ " x  $\frac{3}{8}$ " strip diagonals, cut, fit, and glued to the legs. At this point, paint the structure to suit (oxide red or gray). Now plank the deck with  $\frac{3}{32}$ " x  $\frac{1}{2}$ " strip. These can be stained beforehand or left to weather naturally. Finally, fit, cut, and glue  $\frac{3}{16}$ " x  $\frac{3}{8}$ " strips along the sides of the ramp and deck. These should be treated in the same manner as the planking. The finished platform should be backed up to a siding, just close enough to allow freight cars to pass.

This is an online supplement to the April 2008 issue of *Garden Railways* magazine. To purchase previously published paper plans, see the list of those available at [www.sidestreet.info](http://www.sidestreet.info)

A kit for the Loading Platform (#290) is available from Northeast Narrow Gauge for \$45 + \$7 s&h (to the US). Order from Northeast Narrow Gauge, PO Box 191, Wiscasset ME 04578. Web site: [www.nemodel.com](http://www.nemodel.com)

© 2008 by *Garden Railways* and Northeast Narrow Gauge. These drawings may be reproduced by individual modelers for their own personal use. Copying for any commercial use or for distribution is prohibited without written consent from the publisher.

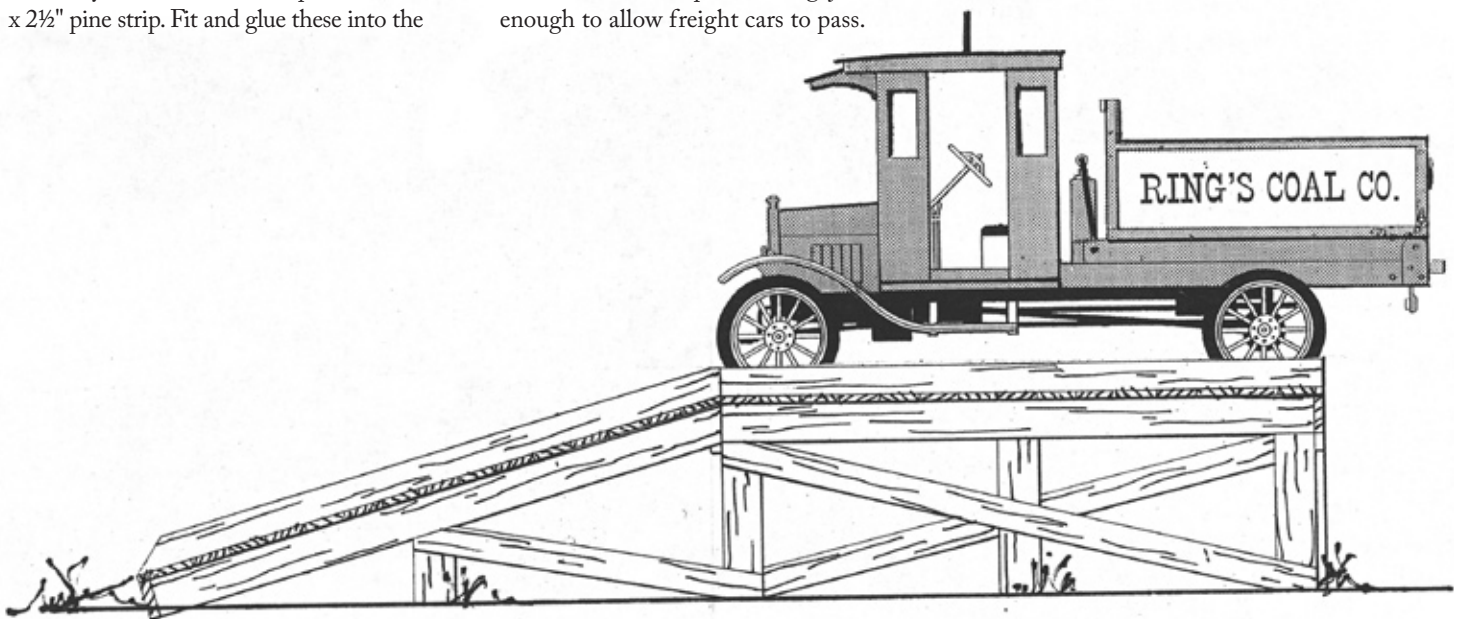

## Are you working in a different scale?

- If you are working in 1:32 scale, reduce these drawings to 63%.
- If you are working in 1:29 scale, reduce these drawings to 70%.
- If you are working in 1:24 scale, reduce these drawings to 88%.
- If you are working in 1:22.5 scale, reduce these drawings to 90%.
- If you are working in 16mm scale, enlarge these drawings to 107%.
- If you are working in 1:13.7 ( $\frac{1}{8}$ " scale), enlarge these drawings to 148%.

side view

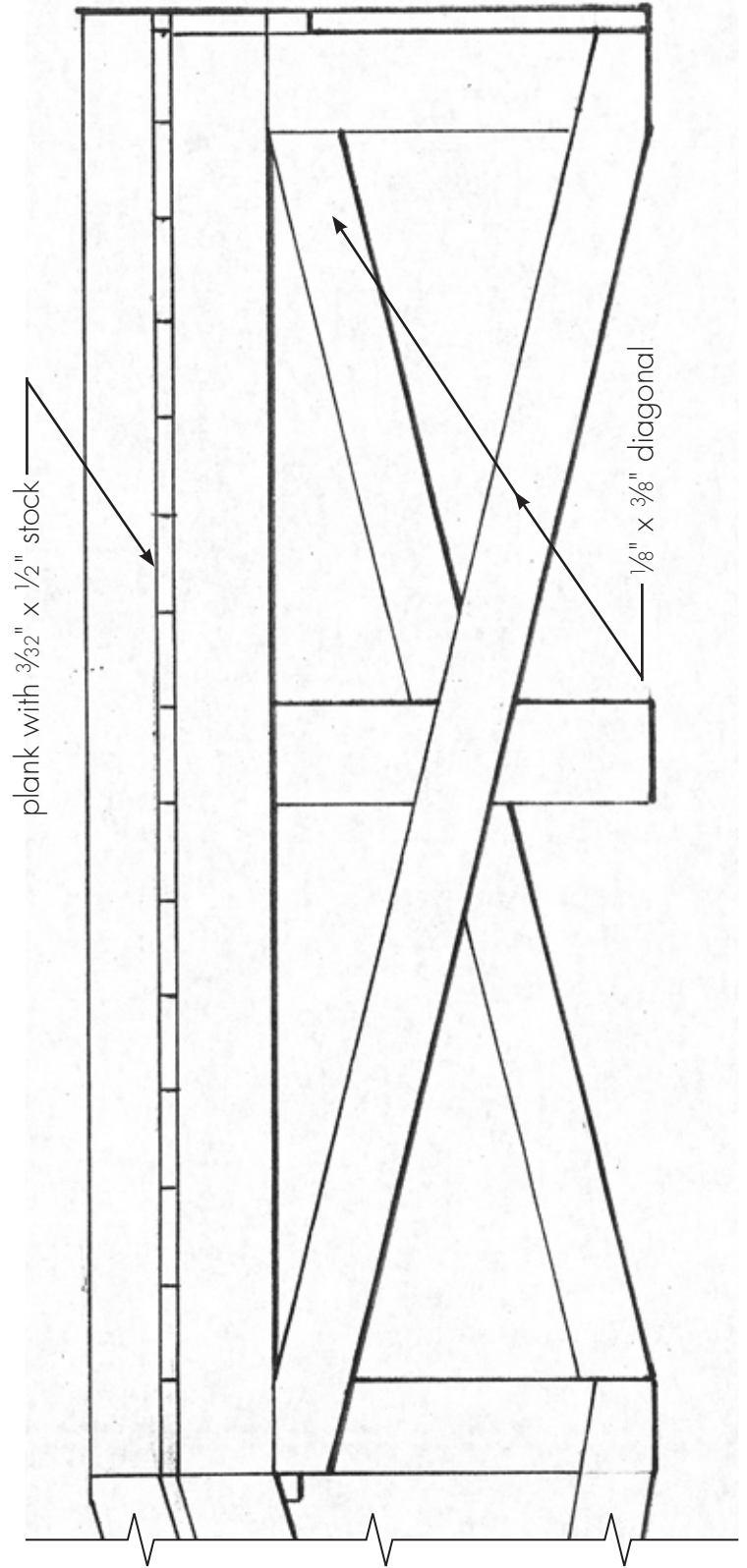
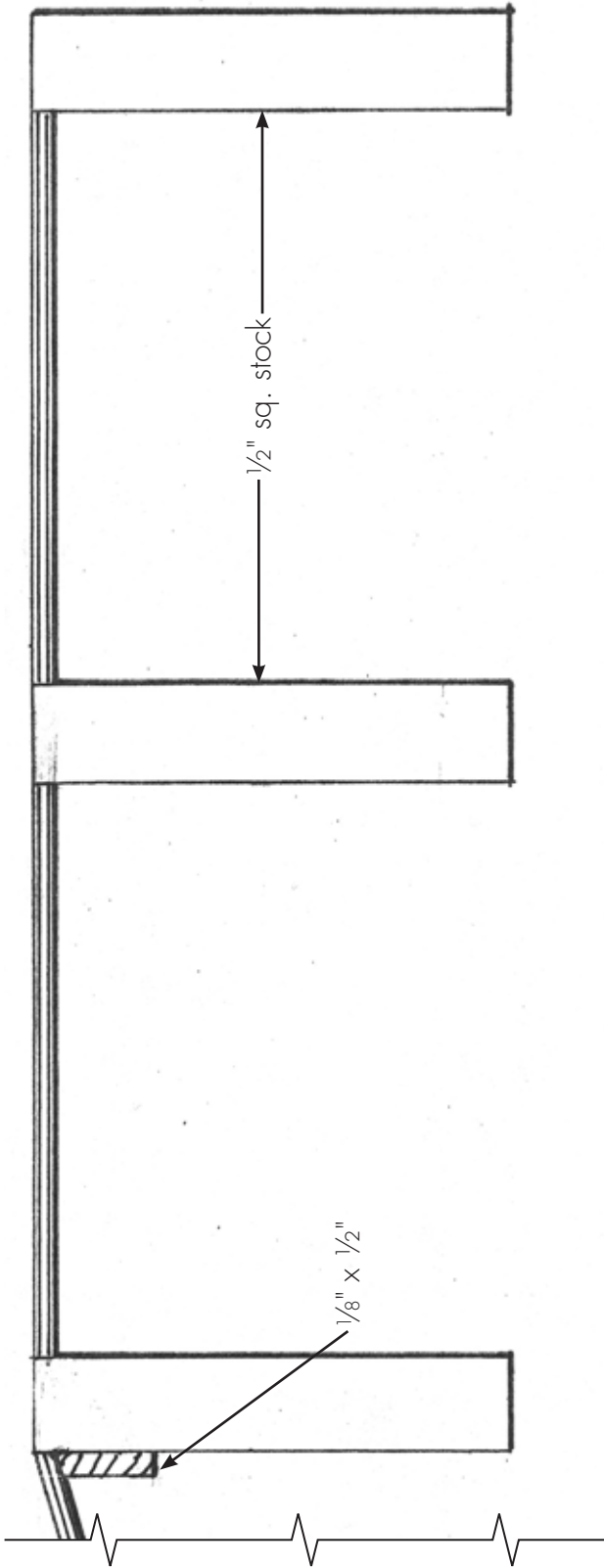

side view

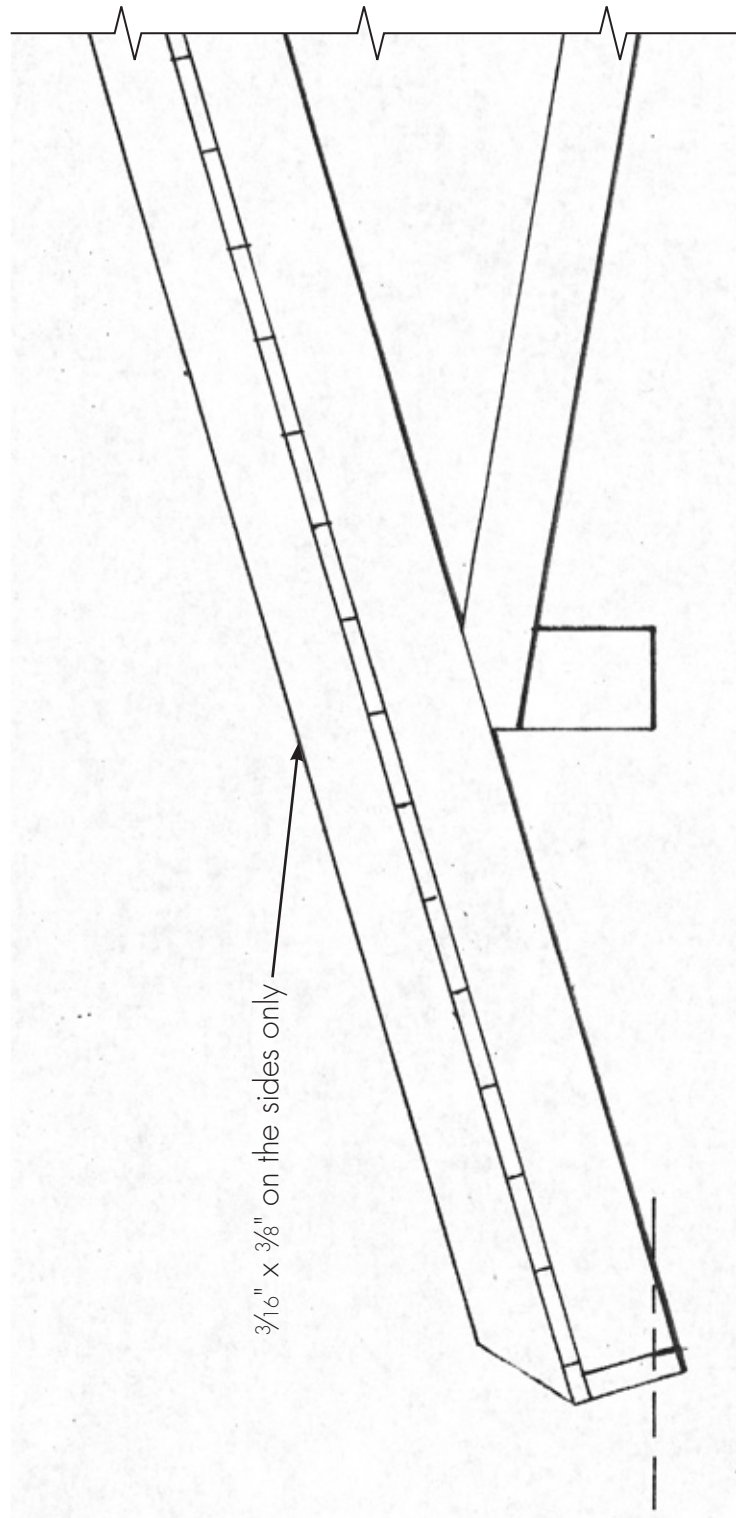
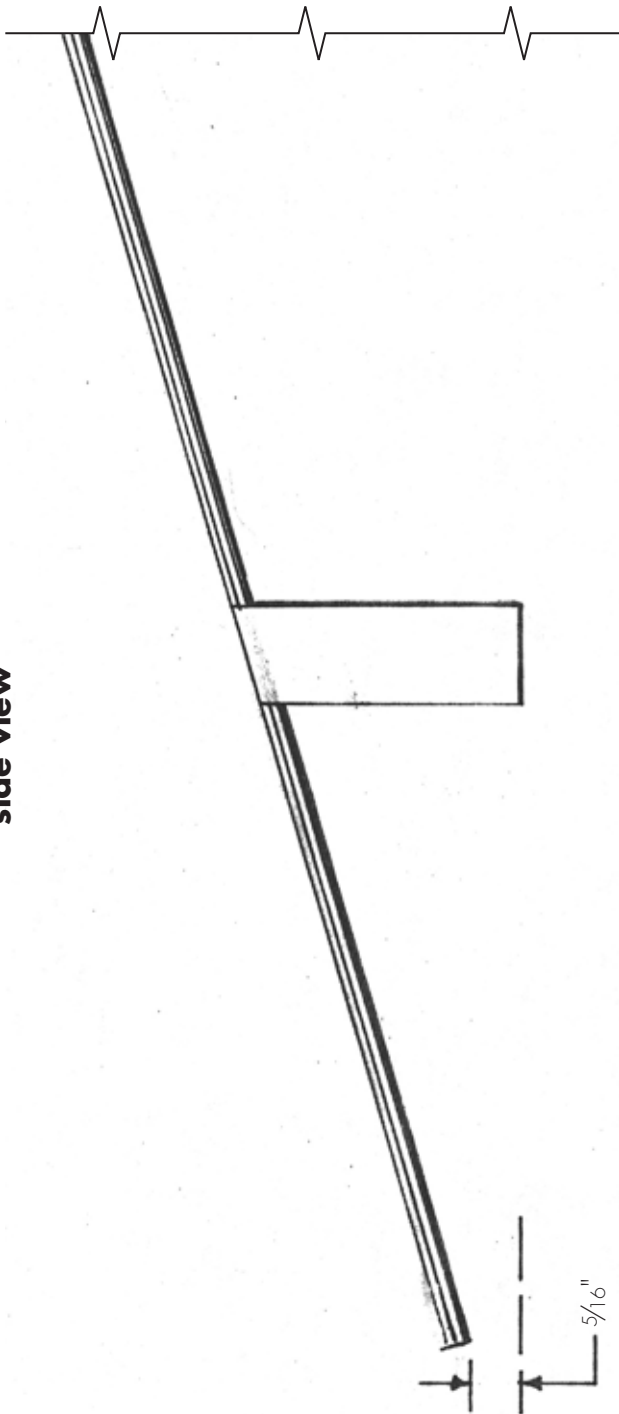

**top view**

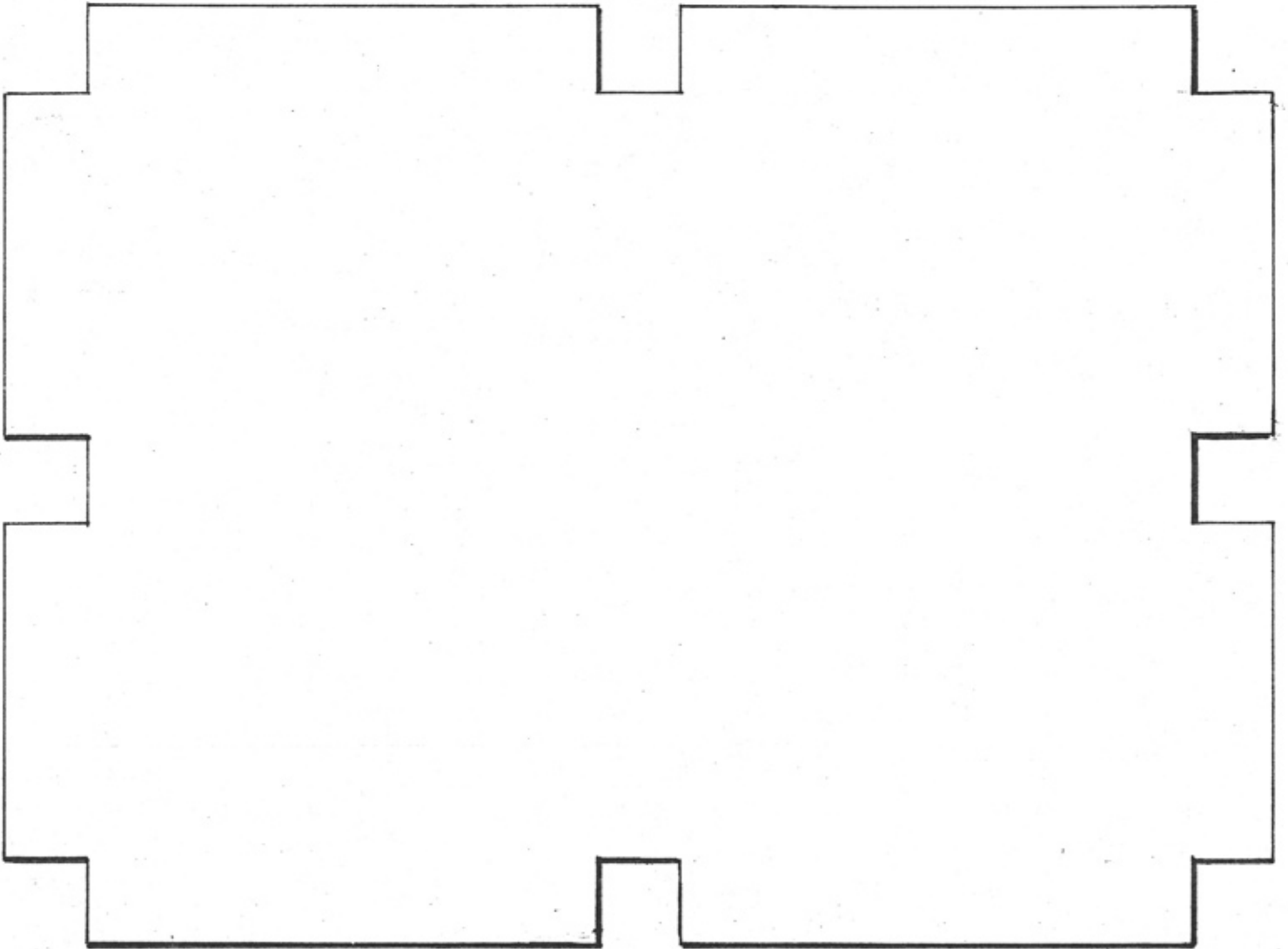

Cut 2 pieces of plywood  $\frac{1}{8}$ " x  $5\frac{1}{2}$ " x  $7\frac{1}{2}$ "

Notch the top piece as shown. The ramp will need only 2 side notches.

end view

